

Rigid IMC

Pull Elbows for Rigid Conduit & IMC

Applications

- Female to Female: For connecting Rigid conduit or IMC to Rigid conduit or IMC to form 90° bend
- Male to Female: For connecting Rigid conduit or IMC to box or enclosures to form 90° bend

Features

- Furnished with neoprene gasketed steel cover and captive screws
- Furnished with steel locknut
- Threaded for Rigid conduit and IMC (Female-NPT, Male-NPSM)

Standard Materials

- Body - Malleable Iron / Ductile Iron
- Gasket - Neoprene
- Cover - Stamped Steel
- Screw - Steel

Standard Finish

- Zinc plated

Applicable Third Party Standards

- UL Standard: 514B
- NEMA: FB-1
- UL Listed File # E207875



Female to Female

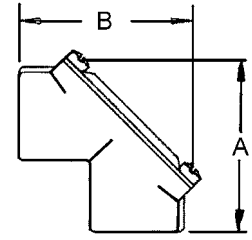

Male to Female

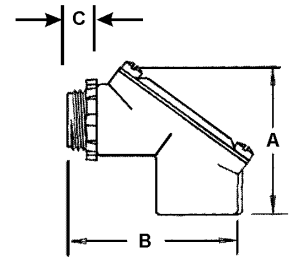

Female to Female 90°

Catalog Number	Trade Size (in)	Dim A (in)	Dim B (in)	Inner Pack	Master Pack	Weight Per C (lb)
PEF-50KON	½	2.188	2.188	10	100	34.4
PEF-75KON	¾	2.313	2.313	5	50	41.5
PEF-100KON	1	3.000	3.063	-	25	64.4
PEF-125KON	1¼	3.625	3.625	-	10	119.0
PEF-150KON	1½	4.063	4.063	-	5	176.4
PEF-200KON	2	4.500	4.500	-	5	268.9

Male to Female 90°

Catalog Number	Trade Size (in)	Dim A (in)	Dim B (in)	Dim C (in)	Inner Pack	Master Pack	Weight Per C (lb)
PEM-50KON	½	2.188	2.438	0.563	20	100	42.8
PEM-75KON	¾	2.313	2.625	0.625	10	50	53.8
PEM-100KON	1	3.063	3.188	0.625	-	25	85.9
PEM-125KON	1¼	3.625	4.063	0.750	-	10	136.7
PEM-150KON	1½	4.063	5.188	0.813	-	10	216.1
PEM-200KON	2	4.500	5.938	0.938	-	5	347.2