

Rigid IMC

Right Angle Clamp and Parallel Conduit Clamps for Rigid Conduit IMC & EMT

Applications

Designed to secure Rigid conduit, IMC, or EMT parallel or perpendicular to beam, channel and angle supports

Features

- Two hex nuts* - SRAC Series
- RoHS compliant

Standard Materials

- Steel U-Bolts and nuts* - SRAC Series
- Malleable Iron / Ductile Iron

Standard Finish

- Right Angle Clamp - Hot-dip galvanized
- Parallel Conduit Clamp - Hot-dip galvanized
- U-Bolt - Mechanically galvanized

Applicable Third Party Standards

- UL Standard: 2239
- UL Listed File # E213669 * SRAC Series only

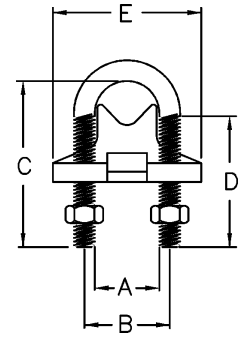

Right Angle Conduit Clamp

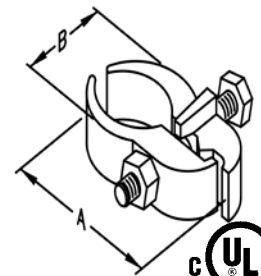

Parallel Conduit Clamp



Right Angle Conduit Clamp

Catalog Number	Trade Size (in)	Dim A (in)	Dim B (in)	Dim C (in)	Dim D (in)	Dim E (in)	Master Pack	Weight Per C (lb)
SRAC50KON*	½	1.000	1.250	2.500	1.813	2.063	50	34.9
SRAC75KON*	¾	1.125	1.375	2.813	1.813	2.250	50	38.6
SRAC100KON*	1	1.375	1.625	3.063	1.813	2.563	50	43.8
SRAC125KON*	1¼	1.750	2.000	3.188	1.813	2.875	25	48.5
SRAC150KON*	1½	2.000	2.375	3.500	1.813	3.250	25	54.8
SRAC200KON*	2	2.500	2.500	4.500	2.625	4.063	25	92.6
SRAC250KON*	2½	3.000	3.250	4.875	2.625	4.500	10	106.5
SRAC300KON*	3	3.625	3.875	5.375	2.625	5.125	10	126.4
SRAC350KON*	3½	4.063	4.563	5.875	2.625	5.625	10	136.0
SRAC400KON*	4	4.688	5.063	6.688	2.625	6.125	10	163.4

Parallel Conduit Clamps

Catalog Number	Trade Size (in)	Dim A (in)	Dim B (in)	Master Pack	Weight Per C (lb)
SPARC50KON	½	2.875	1.438	50	53.8
SPARC75KON	¾	3.063	1.688	50	59.7
SPARC100KON	1	3.250	2.000	50	62.4
SPARC125KON	1¼	3.625	2.125	25	80.6
SPARC150KON	1½	3.875	2.188	25	86.5
SPARC200KON	2	4.625	2.875	25	99.6
SPARC250KON	2½	5.250	3.250	10	130.4
SPARC300KON	3	5.875	3.875	10	161.2
SPARC350KON**	3½	6.313	4.313	10	190.4
SPARC400KON**	4	6.813	4.813	10	210.0

** Not UL Listed