

### Zinc Die Cast Liquidtight Fittings Insulated and Non-Insulated

#### Features

- Tapered threaded male hub NPT
- Compact
- Liquidtight/Raintight/Oiltight/Concrete tight
- Suitable for wet locations

#### Standard Materials

- Zinc Die Cast
- Insuliner Poly carbonate

#### Standard Finish

- Vibratory Finish

#### Applicable Third Party Standards

- UL Standard: 514B
- UL Listed File E207875
- ROHS

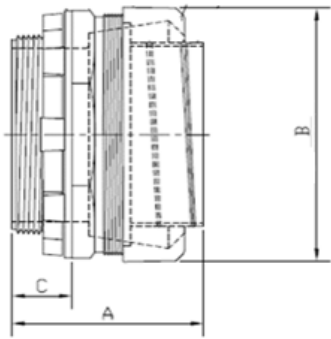

Non-Insulated

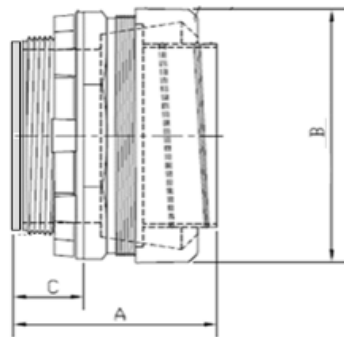

Insulated



Catalog Number	Trade Size (in)	Dim A (in)	Dim B (in)	Dim C (in)	Inner Pack	Master Pack	Weight Per C (lb)
<b>Non-Insulated</b>							
LTD38KON	3/8	1.44	1.30	0.51	25	250	16.0
LTD50KON	1/2	1.44	1.30	0.51	25	250	13.0
LTD75KON	3/4	1.46	1.57	0.51	15	150	19.9
LT0100KON	1	1.87	1.81	0.65	8	80	30.1
LTD125KON	1 1/4	2.01	2.26	0.65	5	50	53.7
LTD150KON	1 1/2	2.07	2.52	0.65	4	40	59.0
LTD200KON	2	1.97	2.99	0.65	2	20	79.3
LT0250KON	2 1/2	3.35	3.74	0.96	1	10	187.8
LTD300KON	3	3.48	4.35	0.96	1	10	268.6
LTD400KON	4	4.07	5.22	0.96	1	6	350.1
<b>Insulated</b>							
LTD38-ICKON	3/8	1.5	1.30	0.57	25	250	16.1
LTD50-ICKON	1/2	1.5	1.30	0.57	25	250	13.1
LTD75-ICKON	3/4	1.52	1.57	0.57	15	150	20.1
LT0100-ICKON	1	1.93	1.81	0.71	8	80	30.9
LTD125-ICKON	1 1/4	2.07	2.26	0.71	5	50	54.0
LT0150-ICKON	1 1/2	2.13	2.52	0.71	4	40	59.2
LTD200-ICKON	2	2.03	2.99	0.71	2	20	82.2
LT0250-ICKON	2 1/2	3.43	3.74	1.02	1	10	188.6
LTD300-ICKON	3	3.56	4.35	1.02	1	10	269.9
LTD400-ICKON	4	4.15	5.22	1.02	1	6	353.4

