

# PVC COATED SEALING FITTINGS EZD FEMALE HUBS W/DRAIN

## Features:

- Exterior PVC coating thickness is a minimum 0.040"
- Interior Urethane coating thickness is a minimum 0.002"
- Sizes available are 1/2" to 2"
- The length of the sleeve extension(s) shall be at least equivalent to the nominal conduit size for sizes 1/2" - 2"
- Mating sealing forms are provided on all caps

## Applications:

Allied Tube & Conduit® PVC Coated Sealing Fittings are used in hazardous locations to prevent flame and gas from continuing to travel through the conduit system. PVC coating provides corrosion protection. A sealing compound should be used on the interior after wiring. Compound supplied by the original fitting manufacturer.



## Standards:

- NEC/CEC:  
EZD 111-611  
Class I, Division 1 & 2,  
Groups C, D Class III
- UL Standard: 1203
- CSA Standard: C22.2

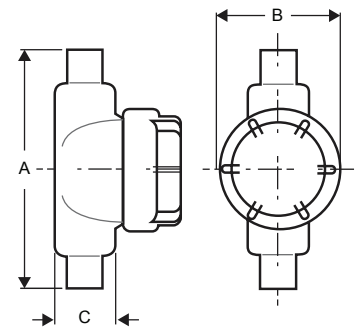

Item Number	Trade Size (in)	Weight per 100 (lbs)	A (in)	B (in)	Turning Radius (in)
For Sealing in Any Position					
PV0500EZD111	1/2	4.19	3.08	3.46	2.06
PV0700EZD211	3/4	4.19	3.08	3.71	2.19
PV1000EZD311	1	4.94	3.58	3.96	2.44
PV1200EZD411	1 1/4	4.94	3.58	4.39	2.63
PV1500EZD511	1 1/2	5.19	3.58	4.64	2.69
PV2000EZD611	2	7.13	5.64	5.33	3.69

